

TERMINAL UNITS

The terminal units for medical compressed gases and vacuum are the points allowing operators in hospitals to connect medical appliances to the gas distribution systems.

MAIN FEATURES:

- Gas-specificity to grant safe connections
- Color code according to international standards
- Available in construction of 1 to 4 units
- According to AFNOR NF-S 90-116/NF-DS 90-119, NIST EN ISO 5359, UNI 9507, DIN 13260, BS 5682, SS 875 24 30 standards
- Possibility of surface or flush mounted installation.

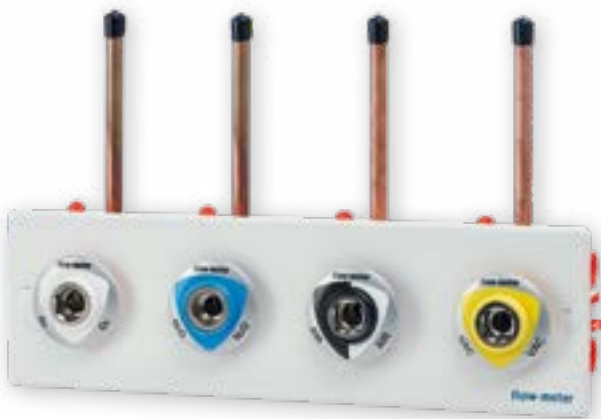

DIN 13260 outlets

FLUSH-MOUNTED INSTALLATION WITH DIN 13260 OUTLETS
(SURFACE INSTALLATION ALSO AVAILABLE)

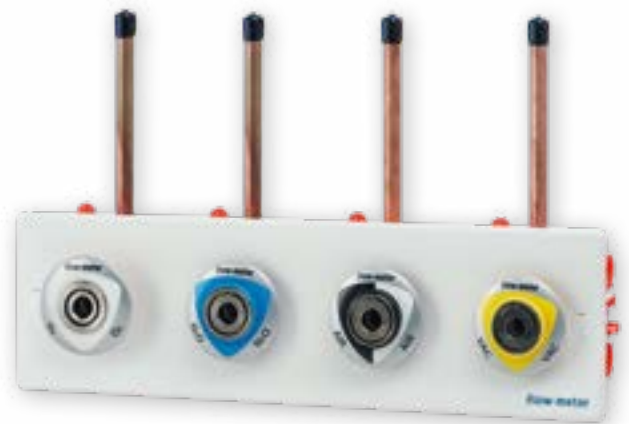

BS 5682 outlets

FLUSH-MOUNTED INSTALLATION WITH BS 5682 OUTLETS
(SURFACE INSTALLATION ALSO AVAILABLE)

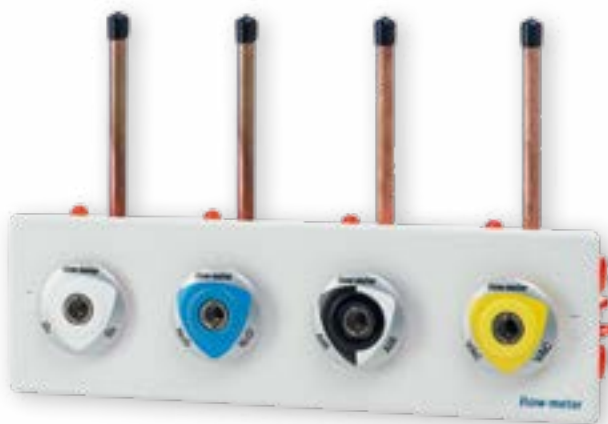

SS 875 24 30 outlets

FLUSH-MOUNTED INSTALLATION WITH SS 875 24 30
OUTLETS (SURFACE INSTALLATION ALSO AVAILABLE)



**AFNOR NF-S 90-116/NF-DS 90-119/
NIST EN ISO 5359 outlets**

FLUSH-MOUNTED INSTALLATION WITH
AFNOR NF-S 90-116/NF-DS 90-119/NIST EN ISO 5359 OUTLETS



UNI 9507 outlets

FLUSH-MOUNTED INSTALLATION WITH
UNI 9507 OUTLETS (SURFACE INSTALLATION
ALSO AVAILABLE)



AFNOR NF-S 90-116/
NF-DS 90-119/NIST EN ISO 5359 outlets

SURFACE INSTALLATION WITH AFNOR NF-S 90-116/
NF-DS 90-119/NIST EN ISO 5359 OUTLETS

TERMINAL UNITS | COMPONENTS | **WALL CASES**

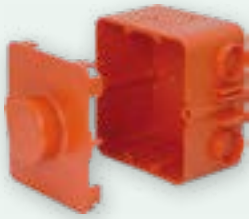

Modular flush-mounted case, complete with disposable panel, suitable for housing **AFNOR NF-S 90-116/NF-DS 90-119, UNI 9507, DIN 13260, BS 5682** and **SS 875 24 30** sockets and outlets.

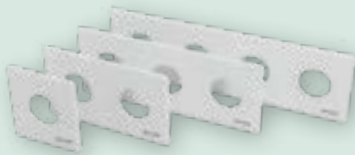

Shiny ABS cover panel for modular flush-mounted cases for **AFNOR NF-S 90-116/NF-DS 90-119, UNI 9507, DIN 13260, BS 5682** and **SS 875 24 30** type outlets. Available with 1, 2, 3 or 4 positions.



Surface mounted case, complete with varnished stainless steel cover panel, with 1, 2, 3 or 4 positions, suitable for housing **AFNOR NF-S 90-116/NF-DS 90-119, UNI 9507, DIN 13260, BS 5682** and **SS 875 24 30** sockets and outlets.



Gases identification labels for **AFNOR NF-S 90-116/NF-DS 90-119/NIST EN ISO 5359** outlets, suitable for fitting on cover panels on modular flush-mounted cases or on surface/mounted cases.



Gases identification labels for **DIN 13260, BS 5682, SS 875 24 30** outlets, suitable for fitting on cover panels on modular flush-mounted cases or on surface/mounted cases.



Plasterboard rail for modular flush-mounted cases.

TERMINAL UNITS | COMPONENTS | **OUTLETS**

Outlet type **AFNOR NF-S 90-116/NF-DS 90-119** for compressed medical gases and vacuum available in the following construction:

- with gas specific thread UNI 9507
- with thread ISO G. 1/4" M.
- with hose connector Ø 6.0 mm for compressed medical gases and with hose connector Ø 7.5 mm for vacuum.



Outlet type **NIST EN ISO 5359** for compressed medical gases and vacuum available in the following constructions:

- with gas specific thread UNI 9507
- with hose connector Ø 6.0 mm for compressed medical gases and with hose connector Ø 7.5 mm for vacuum.



Outlet type **UNI 9507 NEO** with access for simplified maintenance for compressed medical gases and vacuum available in the following constructions:

- with gas specific thread UNI 9507
- with hose connector Ø 6.0 mm for compressed medical gases and with hose connector Ø 7.5 mm for vacuum.



Outlet type **DIN 13260** for compressed medical gases and vacuum.



Outlet type **BS 5682** for compressed medical gases and vacuum.



Outlet type **SS 875 24 30** for compressed medical gases and vacuum.



Outlet type **UNI 9507** with thread for medical gases and vacuum, equipped with parking device.

TERMINAL UNITS | COMPONENTS | **SOCKETS**



Outlet socket with nut for panel mounting for compressed medical gases and vacuum with gas specific thread **UNI 9507**.



Outlet socket for compressed medical gases and vacuum with gas specific thread **UNI 9507**, complete with nut and copper welding tube nipple.



Outlet socket for compressed medical gases and vacuum for **DIN 13260, BS 5682, SS 875 24 30** outlets.



Flush-mounted case with rotating hose positioning

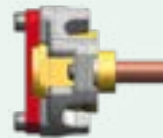

Back hose



Rotating hose nozzle

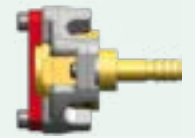

Back hose nozzle

DIN 13260 SOCKET CONFIGURATION

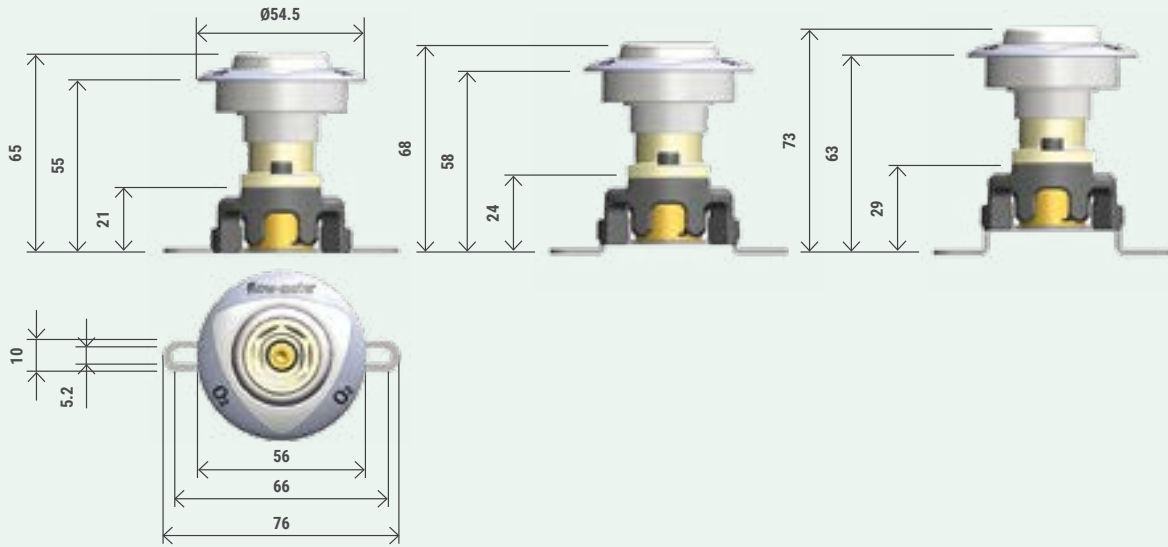

BS 5682 SOCKET CONFIGURATION

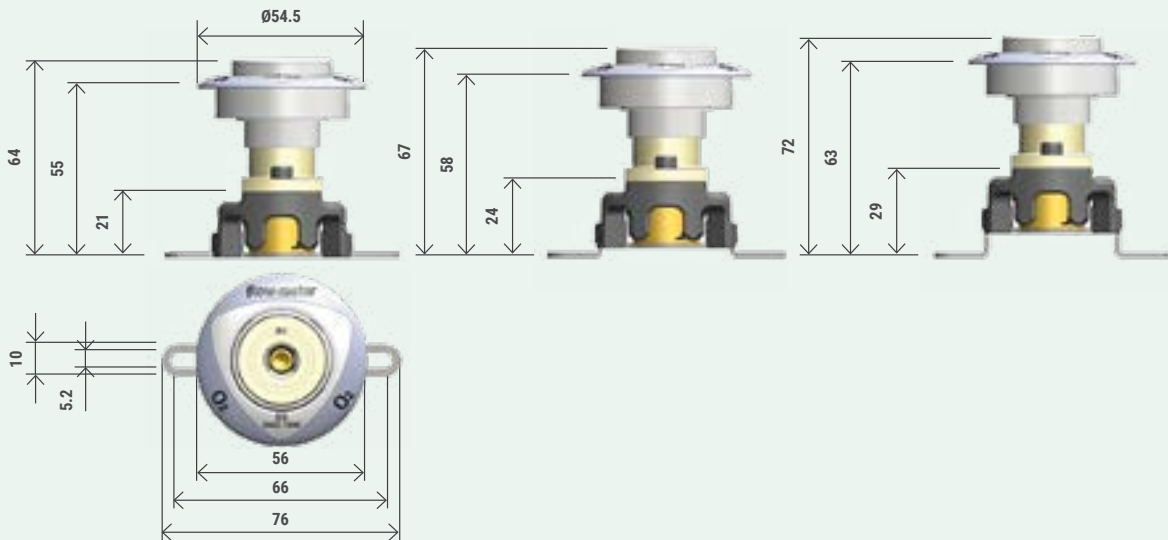

SS 875 24 30 SOCKET CONFIGURATION

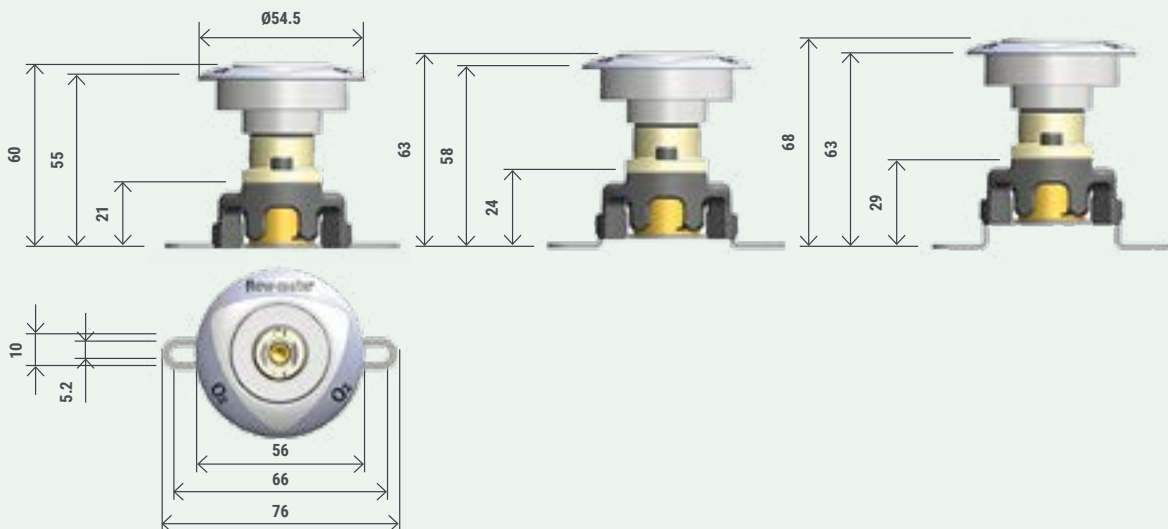

TERMINAL UNITS - DIRECTORY

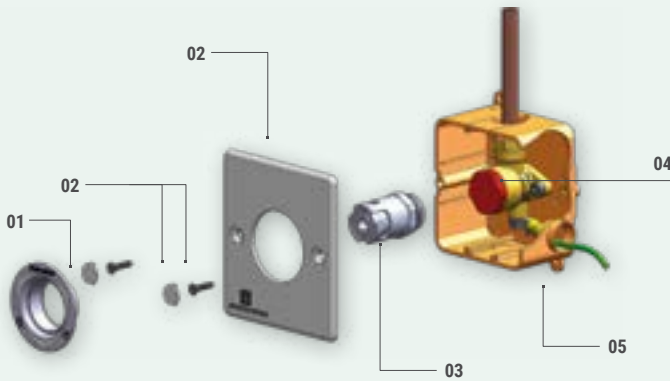

FLUSH-MOUNTED INSTALLATION WITH
**AFNOR NF-S 90-116/NF-DS 90-119/
NIST EN ISO 5359** OUTLETS

DIRECTORY - COMPONENTS DETAIL

- 01. Gas identification label for AFNOR NF-S 90-116/NF-DS 90-119/ NIST EN ISO 5359 outlets
- 02. ABS panel for modular flush-mounted cases with screws
- 03. Outlet type ANOR NF-S 90-116 or NF-DS 90-119 or NIST EN ISO 5359
- 04. Socket with UNI 9507 thread
- 05. Modular flush-mounted case

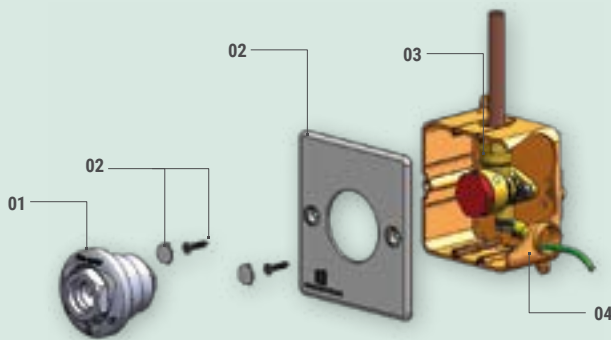

FLUSH-MOUNTED INSTALLATION WITH **UNI 9507** OUTLETS

DIRECTORY - COMPONENTS DETAIL

- 01. Outlet type UNI 9507
- 02. ABS panel for modular flush-mounted cases with screws
- 03. Socket with UNI 9507 thread
- 04. Modular flush-mounted case

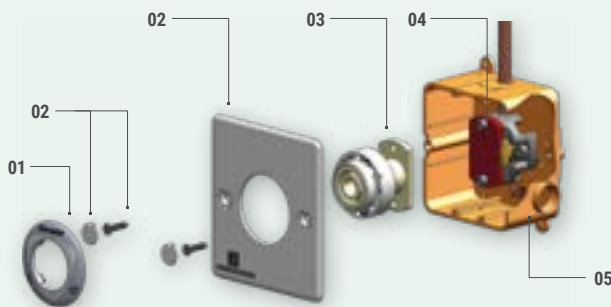

FLUSH-MOUNTED INSTALLATION WITH **DIN 13260, BS 5682, SS 875 24 30** OUTLETS

DIRECTORY - COMPONENTS DETAIL

- 01. Gas identification label for DIN 13260, BS 5682, SS 875 24 30 outlets
- 02. ABS panel for modular flush-mounted cases with screws
- 03. Outlet type DIN 13260 or BS 5682 or SS 875 24 30
- 04. Socket for DIN 13260, BS 5682, SS 875 24 30 outlets
- 05. Modular flush-mounted case

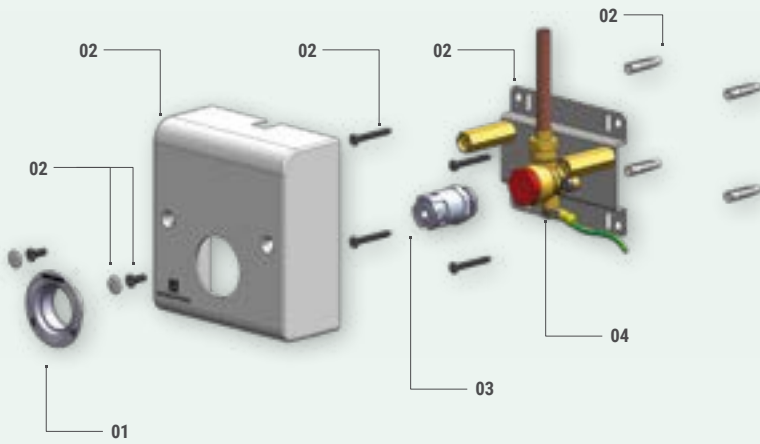

**SURFACE INSTALLATION WITH
AFNOR NF-S 90-116/NF-DS 90-119/
NIST EN ISO 5359 OUTLETS**

DIRECTORY - COMPONENTS DETAIL

- 01.** Gas identification label for AFNOR NF-S 90-116/NF-DS 90-119/ NIST EN ISO 5359 outlets
- 02.** Surface mounted case with screws and spacers
- 03.** Outlet type AFNOR NF-S 90-116 or NF-DS 90-119 or NIST EN ISO 5359
- 04.** Socket with UNI 9507 thread

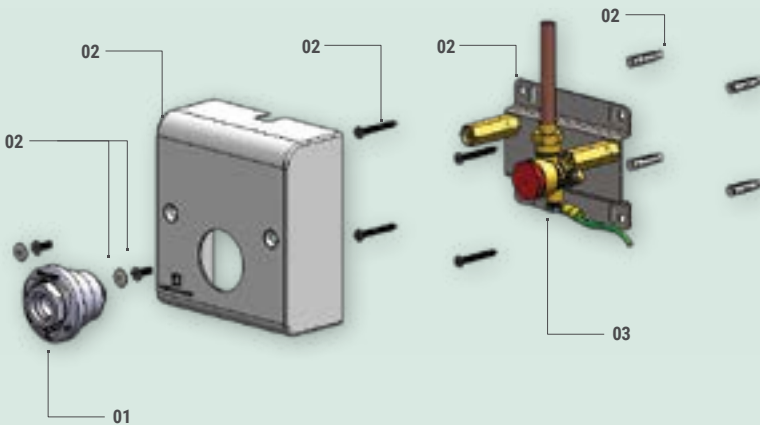

**SURFACE INSTALLATION WITH
UNI 9507 OUTLETS**

DIRECTORY - COMPONENTS DETAIL

- 01.** Outlet type UNI 9507
- 02.** Surface mounted case with screws and spacers
- 03.** Socket with UNI 9507 thread

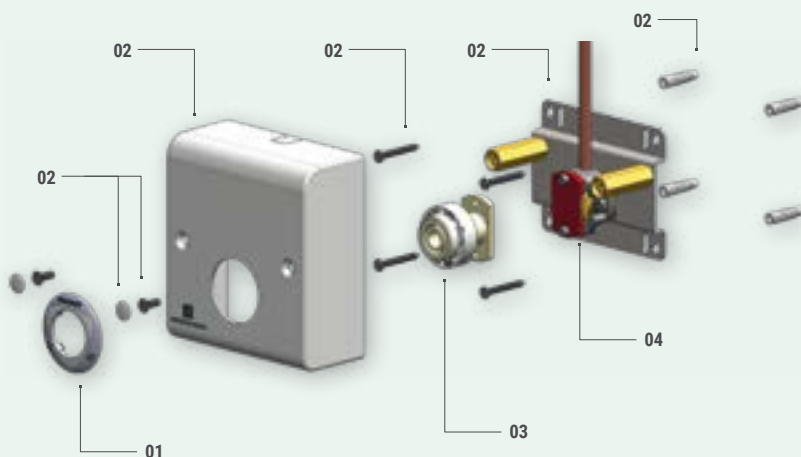

**SURFACE INSTALLATION WITH
DIN 13260, BS 5682, SS 875 24 30
OUTLETS**

DIRECTORY - COMPONENTS DETAIL

- 01.** Gas identification label for DIN 13260, BS 5682, SS 875 24 30 outlets
- 02.** Surface mounted case with screws and spacers
- 03.** Outlet type DIN 13260 or BS 5682 or SS 875 24 30
- 04.** Socket for DIN 13260, BS 5686, SS 875 24 30 outlets